



# Imagine<sup>®</sup>



Each Imagine infrared product was designed by our own engineering department and is a fresh new concept in infrared control. We have taken the most popular audio/video control system in use today and updated it to a new level. We believe we have created the easiest to use, most reliable, most elegant infrared control system on the market.

Robust construction, comprehensive noise shielding, system features never offered at this price level, surface mount technology, built-in installer aids, along with a fit and finish without comparison are all part of the Imagine experience.

Unlike most manufacturers who purchase and resell private labeled infrared components, Buffalo Electronics manufactures the complete Imagine infrared product line. You will receive fair direct pricing without layers of mark-up along with reasonable delivery times and good technical support.

Imagine infrared repeaters are used to receive hand held remote control signals in any room. The control signals are sent to the Imagine infrared connecting system. The connecting system then controls the audio/video equipment as required. Installation is fast and easy with most wiring systems.

## IR-250

DECORA™ SMT SLIM-LINE J-BOX REGULATED INFRARED REPEATER :

This ultra thin, 1/2" deep, high performance voltage regulated repeater installs easily in any electrical box. Extra J-Box wiring space can be gained using this repeater. Available in the DECORA™ style white or Ivory.

## IR-350

SMT TUBE STYLE REGULATED EASY CONNECT INFRARED REPEATER :

This standard size, 1/2" diameter, high performance voltage regulated tube repeater installs easily with a built-in terminal block connector. Tube repeaters offer many installation options to achieve a clean and uncluttered look. All installation and trim hardware is included.

## PRODUCT FEATURES:

### IR-250 SMT SLIM-LINE J-BOX REGULATED REPEATER

- Surface mount technology for superb noise immunity, low current draw, and long term reliability
- Voltage regulation for consistent sensitivity room to room and power supply noise Immunity
- Approximate range in ambient light is 40 ft. with an acceptance angle of 130 degrees
- A hidden, pin-light LED flashes confirmation when an infrared signal is received
- Extensive shielding and special ground plane PCB design create a robust noise shield
- Terminal block connector easily accepts up to 16 gauge wire
- Installs in any standard electrical box or P-ring

### IR-350 SMT TUBE STYLE REGULATED EASY CONNECT REPEATER

- Surface mount technology for superb noise immunity, low current draw, and long term reliability
- Voltage regulation for consistent sensitivity room to room and power supply noise Immunity
- Approximate range in ambient light is 40 ft. with an acceptance angle of 130 degrees
- LED flashes confirmation when an infrared signal is received
- The brass tube and special ground plane PCB design Provide excellent noise shielding
- Connector easily accepts 16 gauge wire
- Installs in any standard 1/2" mounting hole
- Black easy grip mounting nut
- Both daylight filter lens and clear lens included

## IR-250 & IR350

IR REPEATERS  
INFRARED REMOTE CONTROL SYSTEM

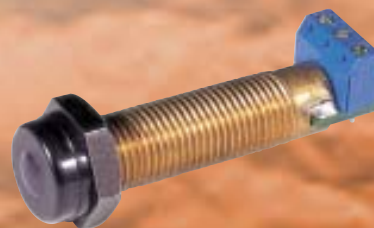



# Imagine

## INSTALLATION INSTRUCTIONS

### IR-250 & IR-350

INFRARED REPEATERS  
INFRARED REMOTE CONTROL SYSTEM

#### IR-250 MOUNTING REQUIREMENTS:

This unit is wall mounted and can be installed in any standard electrical box or P-ring. When installed the unit extends only 1/2" into the wall. Mount the device at the same height as installed light switches for best appearance.

#### IR-350 MOUNTING INSTRUCTIONS:

This unit easily installs in a 1/2" diameter hole. The unit comes with a mounting nut and lens. Typical installation locations include: inside speakers; equipment cabinets; ceilings; walls; and various other "hidden" locations.

#### PREWIRE RECOMMENDATIONS:

We recommend that you use a 2 twisted pair shielded low capacitance (< 20 pF per foot) cable. The systems power (V+) and signal (SIG) use one twisted pair. System ground (GND) can use both wires of the second twisted pair. The shield can be grounded in difficult installations to improve performance by eliminating external noise interference.

For best results use 22 gauge cable for 1-100' runs; 20 gauge cable for 101-200' runs; and 18 gauge cable for runs greater than 200'.

When running IR cable inside walls most states and municipalities specify that you must use a special type of cable that is fire rated such as CL-2 or CL-3. In order to avoid noise interference and code violations never install low voltage and 115-Vac components in the same electrical box.

#### ROOM PLACEMENT:

The IR-250 and IR-350 infrared repeaters receive signals from a hand held remote control up to 40 feet away with an acceptance angle of 130 degrees.

Install the IR-250 in a wall in front of the homeowners sitting area where the infrared remote control will be used.

Install the IR-350 in a convenient hidden location to give today's clean uncluttered look.

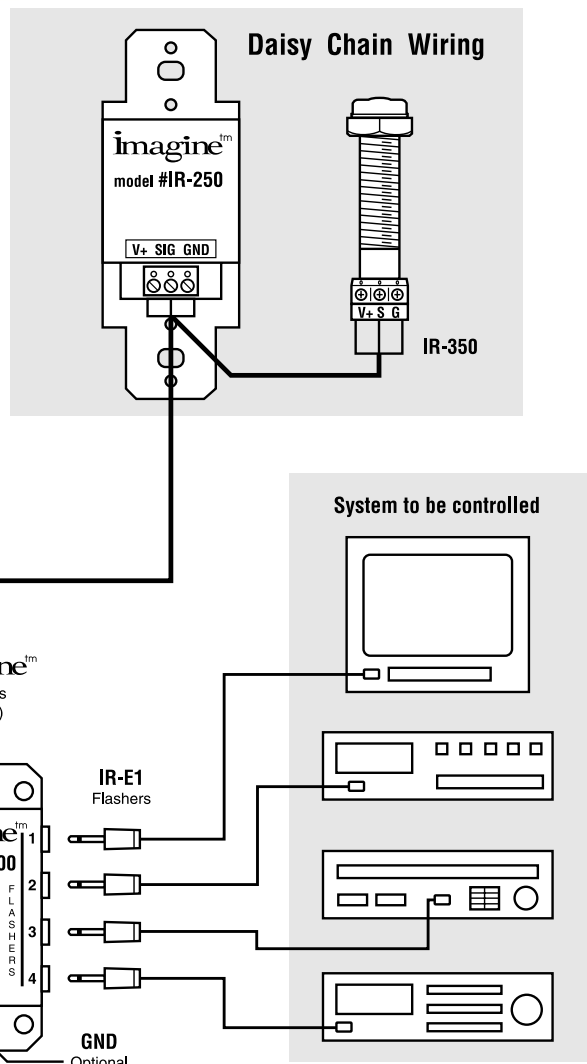

[http:// www.buffaloelectronics.com](http://www.buffaloelectronics.com)

Imagine® is a registered trademark of Buffalo Electronics, Inc.

#### Sales, Distribution & Support

1001-D West Tremont Ave.  
Charlotte, NC 28203  
Orders: (888) 822-2410  
Phone: (704) 375-3445  
Fax: (888) 453-0538

#### Engineering & Manufacturing

5/11 Moo 1, Soi Phetkasaem 63,  
Laksong, Bangkok,  
Bangkok 10160, Thailand  
Phone: 011-662-801-7608  
Fax: 011-662-801-7609

REV.B1.RPT

